

dametric 

AGS-SP-CS1

AIR COOL SYSTEM FOR THE AGS SENSOR

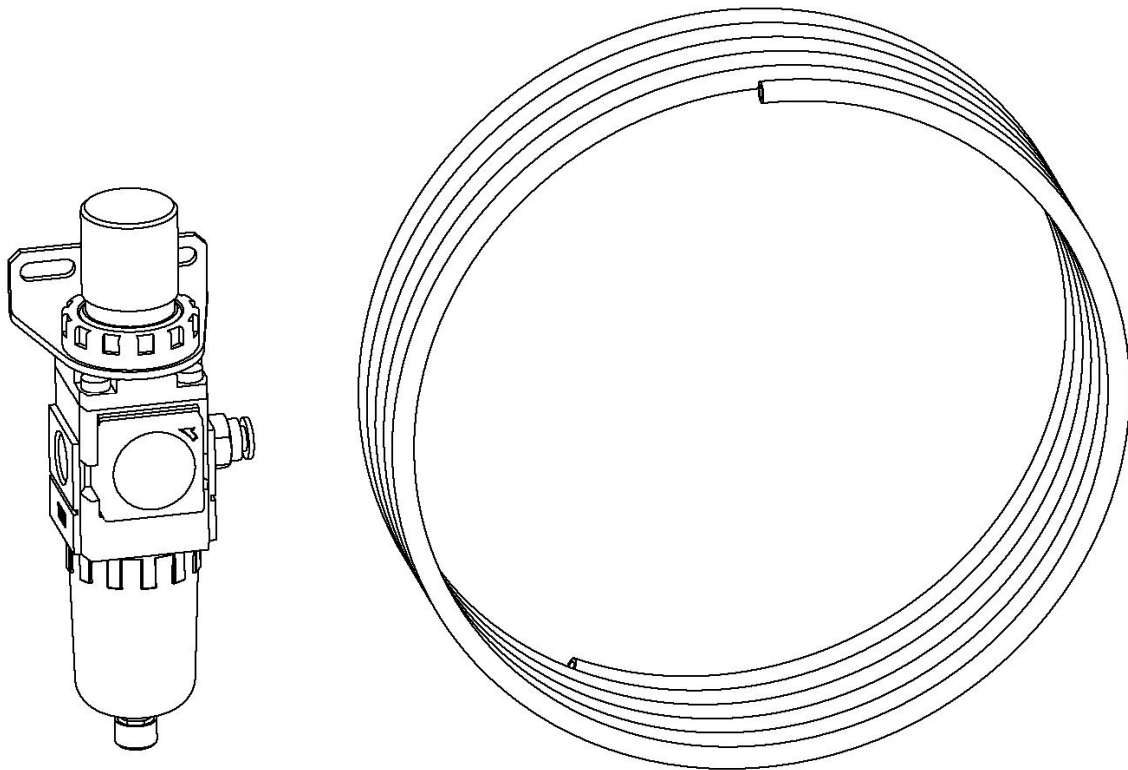

DESCRIPTION

CONTENT

1	GENERAL.....	2
2	SPECIFICATION.....	2
3	AIR CONSUMPTION	2
4	MOUNTING.....	3
5	OUTLINE DRAWING	3
6	VALMET PART NO	3
7	CONTACT.....	3

1 GENERAL

The AGS-SP-CS1 is an air cooling system for the AGS sensor. The unit includes a pressure regulator, an air filter and a flexible tube to supply cooling air to the AGS sensor. It is essential that the system is fed with clean and dry instrument air because the air flows direct through the sensor. The unit is mounted on or close to the AGS connection box so the air tube can be attached to the 3 m electric AGS cable between the connection box and the sensor. One unit feeds one AGS sensor which means that two units are installed if two AGS sensors are used.

2 SPECIFICATION

Supply air:	The supply air must be dry and clean according to the specification ISA S73-1975(R1981). The temperature should be at least 10 ° lower than the ambient temperature.
Air inlet:	G1/4 thread. Appropriate air fitting to be mounted at installation
Air tube to the AGS:	6mm, black, 3.5 m long
Maximum inlet pressure:	1 MPa (= 10 bar, = 145 PSI)
Adjustable pressure range	0.01 to 0. 20 MPa (1.5 – 29 PSI)
Normal outlet pressure	0.05 MPa (7.2 PSI)
Indication:	Pressure monitor, 0 – 0.20 MPa, (0-29 PSI)
Air filter grade:	5 micron
Air filter drainage:	Manual

3 AIR CONSUMPTION

The air consumption is dependant of the set pressure:

Pressure		air consumption
MPa	PSI	litres/minute
0.02	2.9	24
0.04	5.8	36
0.05	7.2	40 Suggested setting
0.06	8.7	50
0.08	11.6	60
0.10	14.5	70

The air consumption is measured with a 3.5 meter long air tube to the AGS sensor.

4 MOUNTING

Mount the unit on the cover to the connection box, KB-AGS1R, or close to the box. Locate the air tube along with the K-AGS3 cable and tie up with bundles. The air tube can be cut but keep the length to at least 2.5 meter. The supplied 6 mm air tube is 3.5 meter long.

Mount an appropriate air fitting to the inlet of the unit, the thread is G1/4.

Keep the inlet piping from hot parts to avoid unnecessary heating of the inlet air. Use thermal insulated piping preferably mounted under the refiner.

Lift the knob and adjust the set pressure according to the table above, nominally 0.05 MPa. Push down and lock the knob.

5 OUTLINE DRAWING

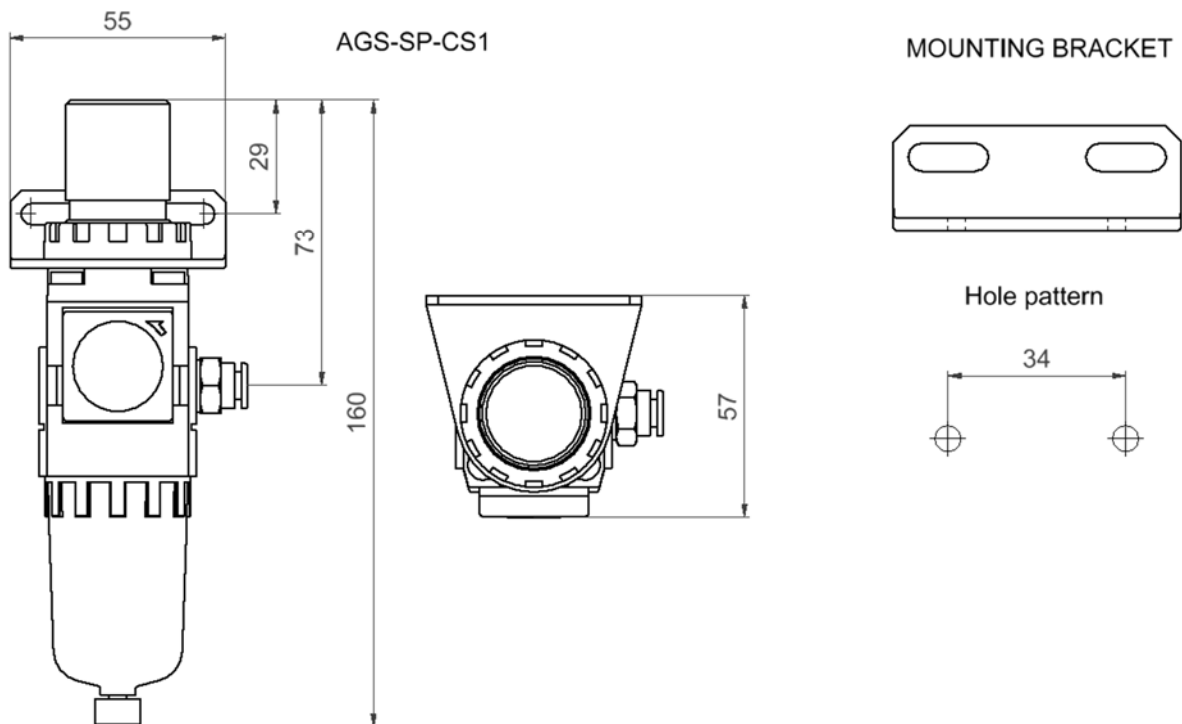

6 VALMET PART NO

Valmet part no.: VAL0322341.

7 CONTACT

Sales, development, production and service:

Dametric AB

Jägerhorns Väg 19, 141 75 Kungens Kurva, Sweden

Phone: +46-8 556 477 00

e-mail: ags@dametric.se

Telefax: +46-8 556 477 29

Web site: www.dametric.se

dametric 

Valmet 