

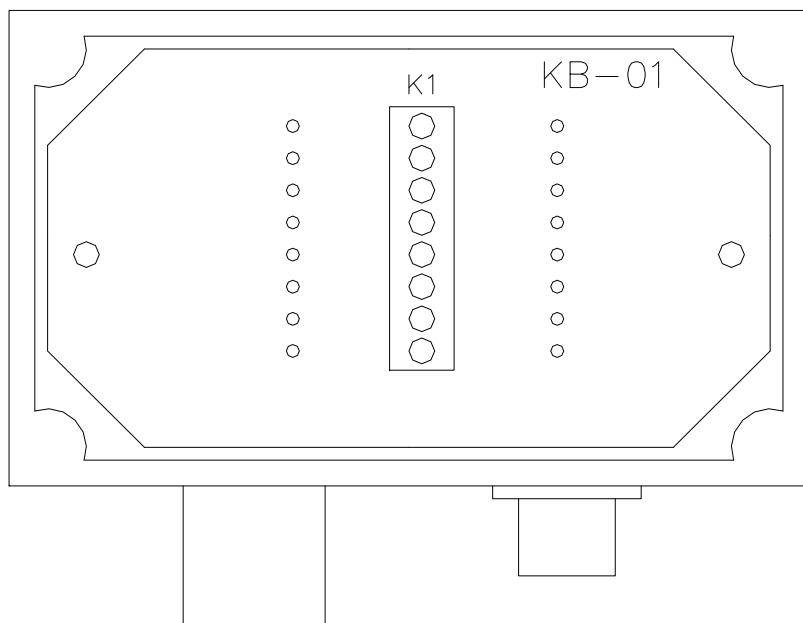

# KB-01

VAL0122852 / SKC8331960



## CABLE BOX TECHNICAL DESCRIPTION



## 1 TECHNICAL DATA

Connectors:	6-pole screw connector for signal
Max cable area:	1.5 mm <sup>2</sup> (multi leader) alt 2.5 mm <sup>2</sup> (single leader)
Max voltage:	250 Vac
Max current:	8A
Cable area:	5-8 mm

## 2 COMPONENT SPECIFICATION

Component	Number	Article	Description
K 1	1	PLINT 6	Screw connenctor
M 1	1	LÅDA 100T	Plastic box 125*75
M 2,3	2	MS-3.9*9.5	Screw
M 4,5	2	FÖRSK. 5-8	Conduit entry
CB 1	1	PCB 8501	Circuit board

## 3 OUTLINE DRAWING

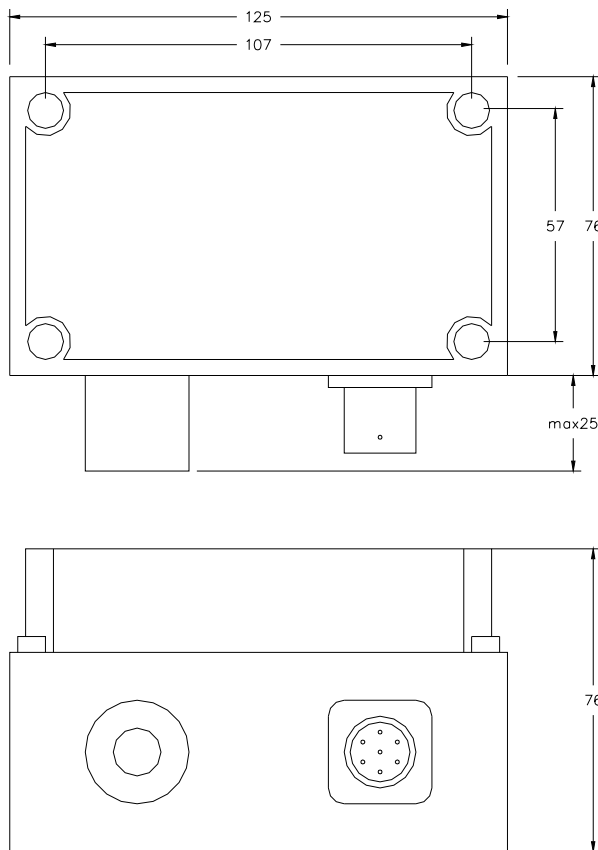

## 4 CONTACT

Sales, development, production and service:

### Dametric AB

Jägerhorns Väg 19, SE 141 75 Kungens Kurva, Sweden  
 Phone: +46-8 556 477 00      Telefax: +46-8 556 477 29  
 E-Mail: [service@dametric.se](mailto:service@dametric.se)      Website: [www.dametric.se](http://www.dametric.se)

dametric 

Valmet 