

dametric 

CM-2NM12

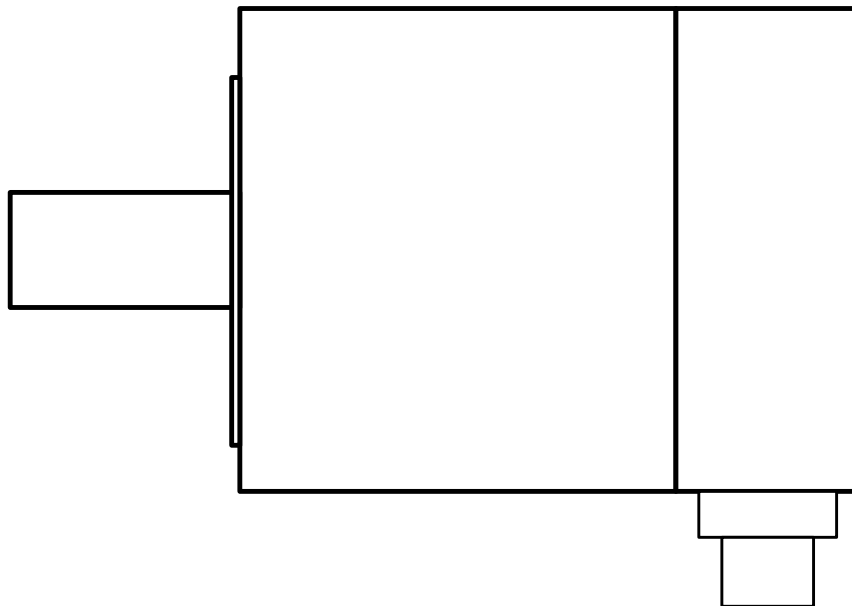

VAL0165086
SKC2037136

CONTROL STEPPING MOTOR TO RCS/GMS
SYSTEM

USERS MANUAL



Table of Contents

1. General 2
 2. Technical Specification 2
 3. Connection Diagram 2
 4. Outline Drawing 3
 5. CONTACT 3

1. General

The CM-2NM12 is a two-phase electric stepping motor used for control the guide valve on a pulp refiner. The Control Motor Driver (CMD-DM1) in the RCS/GMS cabinet powers and controls the motor. Due to variation of the thread pitch on the control rod on the motor, a set of parameters in the CMD-DM1 is used to get an accurate stroke length.

2. Technical Specification

Step angle	1.8 °
Step angle accuracy	±5 %
Related phase current	3.1A
Phase resistance	1.36Ω
Phase inductance	11.0 mH
Holding torque	4.5 nm
Detent torque	0.13 nm
Rotor inertia	1.4 kgcm ²
Radial shaft load	220 N (middle)
Shaft thrust load	60 N
Mass	2.5 kg

3. Connection Diagram

Connect the K-CM25 cable to the motor terminal box.

CM-2NM12	Terminal	K-CM25
red	1	white
black	2	brown
green	3	green
white	4	yellow
	GND	shield

4. Outline Drawing

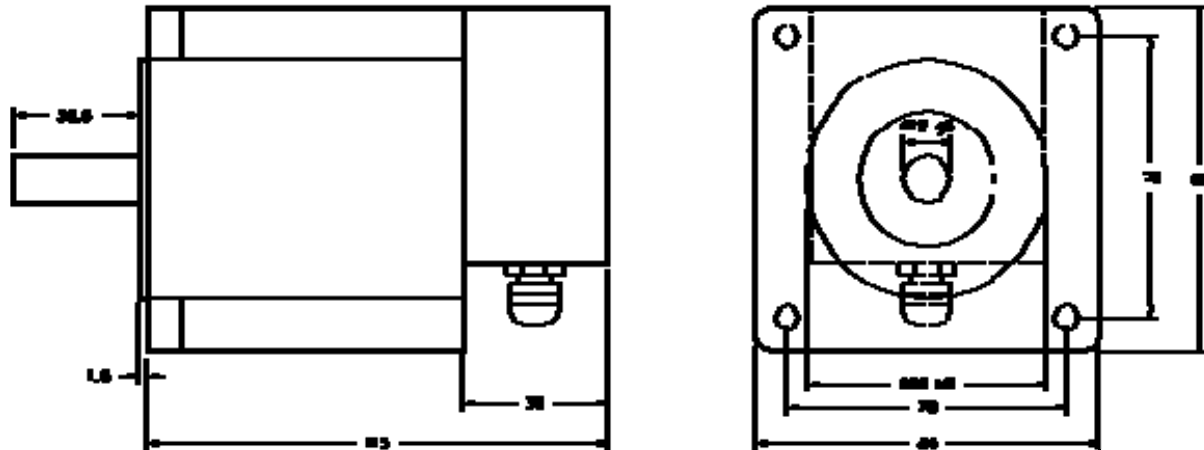

5. CONTACT

Sales, development, production and service:

Dametric AB

Jägerhorns Väg 19, SE 141 75 Kungens Kurva, Sweden

Phone: +46-8 556 477 00

Telefax: +46-8 556 477 29

E-Mail: service@dametric.se

Website: www.dametric.se

dametric 

Valmet 